

# Replacing an Altice One Mini

Before you start, press 7 and 9 simultaneously on your Altice One remote, then disconnect everything from your existing Mini.

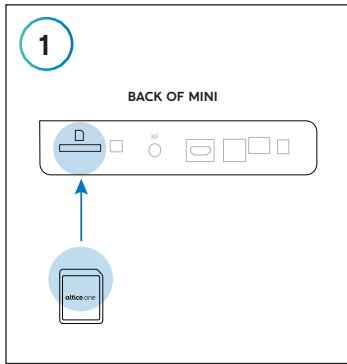

Insert the SD card (included in the box) into the card slot on the back of the new Mini.

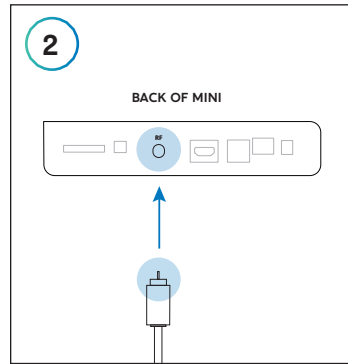

Connect the coaxial cable from your wall outlet to the "RF" port on the back of the Mini.

**Make sure the connection is finger tight.**

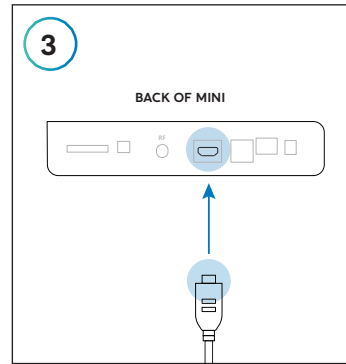

Plug one end of the HDMI cable into the **TV/OUT HDMI port** on the back of the Mini and the other into **one of the HDMI ports** on the back of your TV.

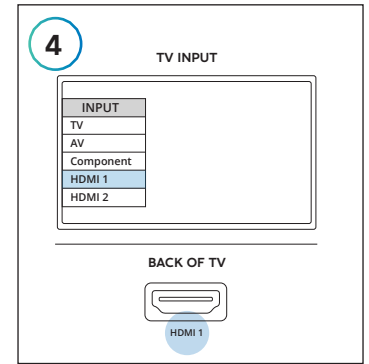

**Turn on your TV** and make sure the input source matches the HDMI port you plugged the cable into in step 3.

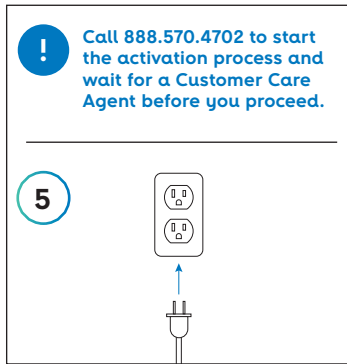

**When you've reached an Agent,** plug the Mini power cord into an electrical outlet.

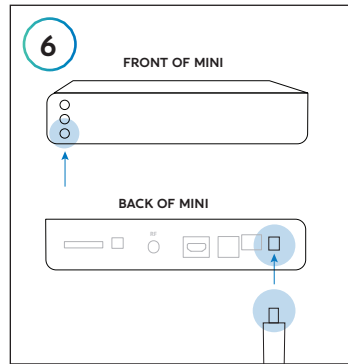

Press and hold the power button on the front of the Mini and **at the same time** plug the other end of the power cord into the Mini.

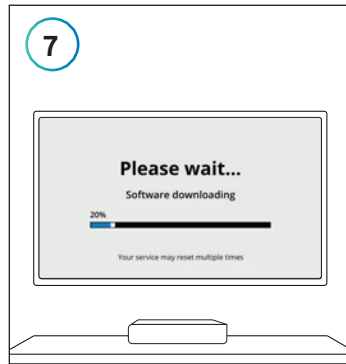

Release the power button when you see the "Software downloading" screen. **Allow up to 10 minutes** for your Mini to configure. It will **turn on and off several times** during the process.



**When you see the "Connect your box" screen,** follow **step 9A or 9B** depending on your equipment.

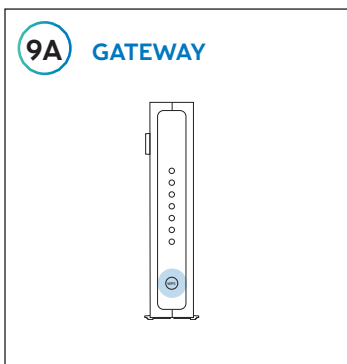

If you're using your **Mini with a Gateway,** press and hold the WPS button on the front of your Gateway for 5 seconds then release to put it into pairing mode.

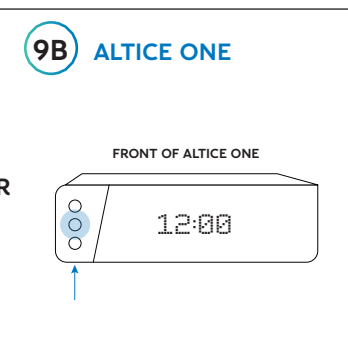

If you're using your **Mini with Altice One,** press the WPS button on the front of Altice One. You'll see **"WPS Pairing Mode"** on the display when it's in pairing mode.

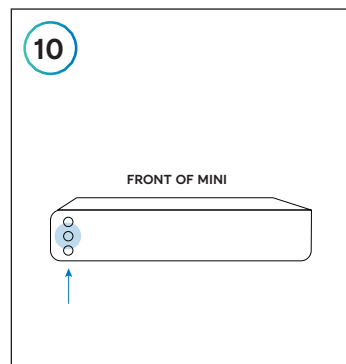

Go to the Mini and press and hold the WPS button on the front for 10 seconds. **The button will blink then turn solid white** when the Mini is paired.



**Wait a few minutes until you see the "Let's Get Started" screen,** then follow the on-screen instructions to complete the setup.

**12** Make sure to return your old Mini within 15 days to avoid being further billed. For instructions, visit [suddenlink.com/returns](https://www.suddenlink.com/returns)